

# torre de controle

escala: 1/200

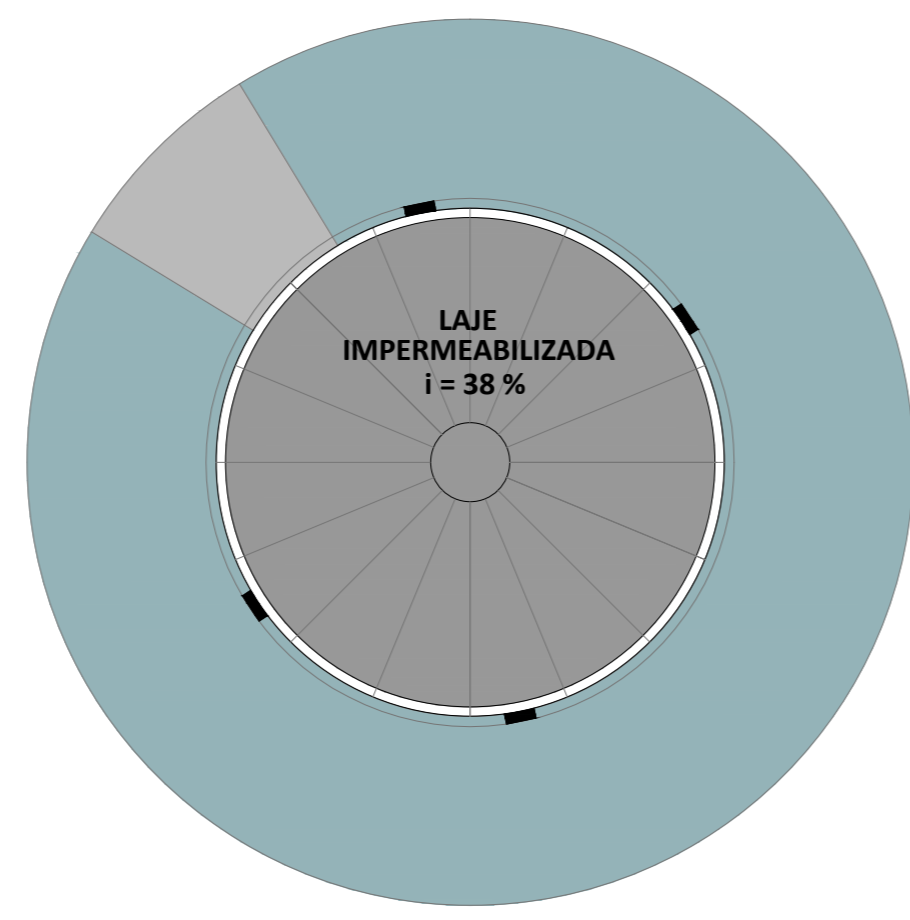

. planta de cobertura

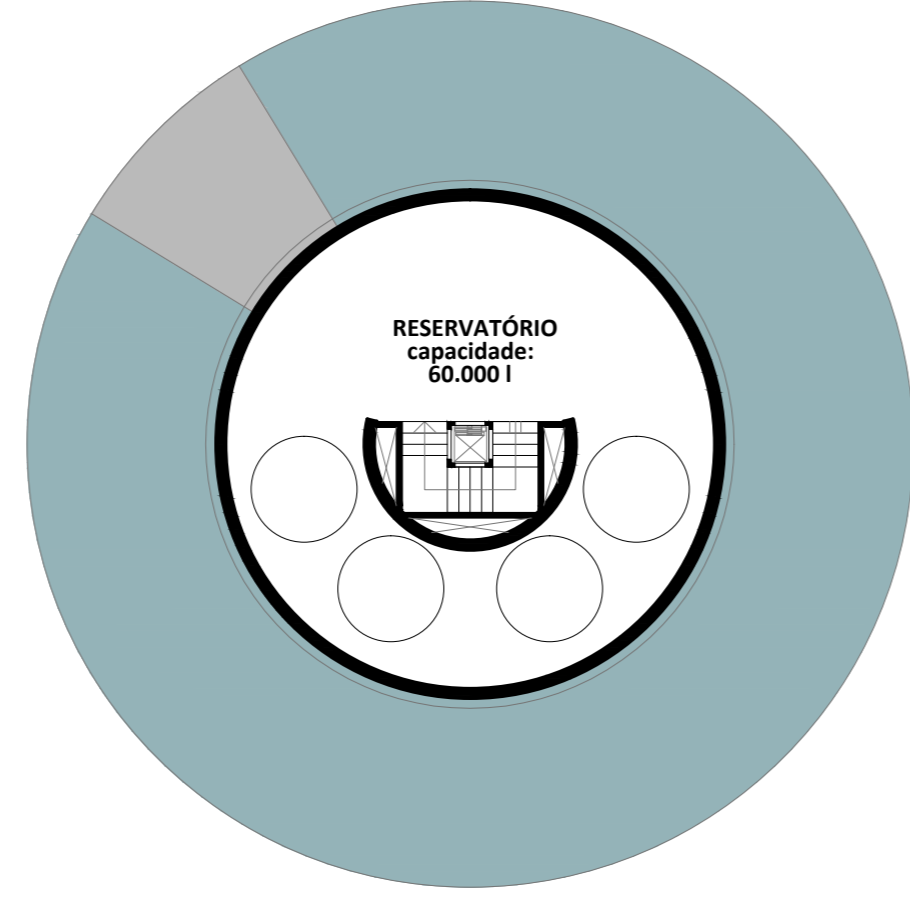

4º pavimento - reservatório

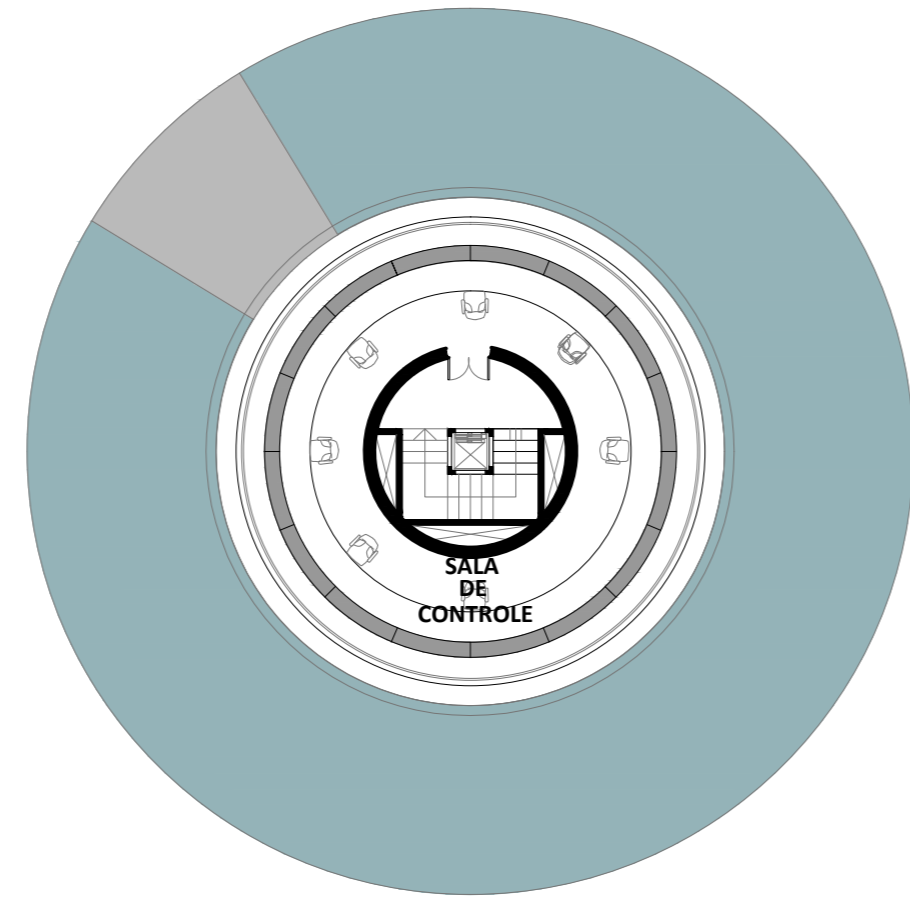

3º pavimento - sala de controle

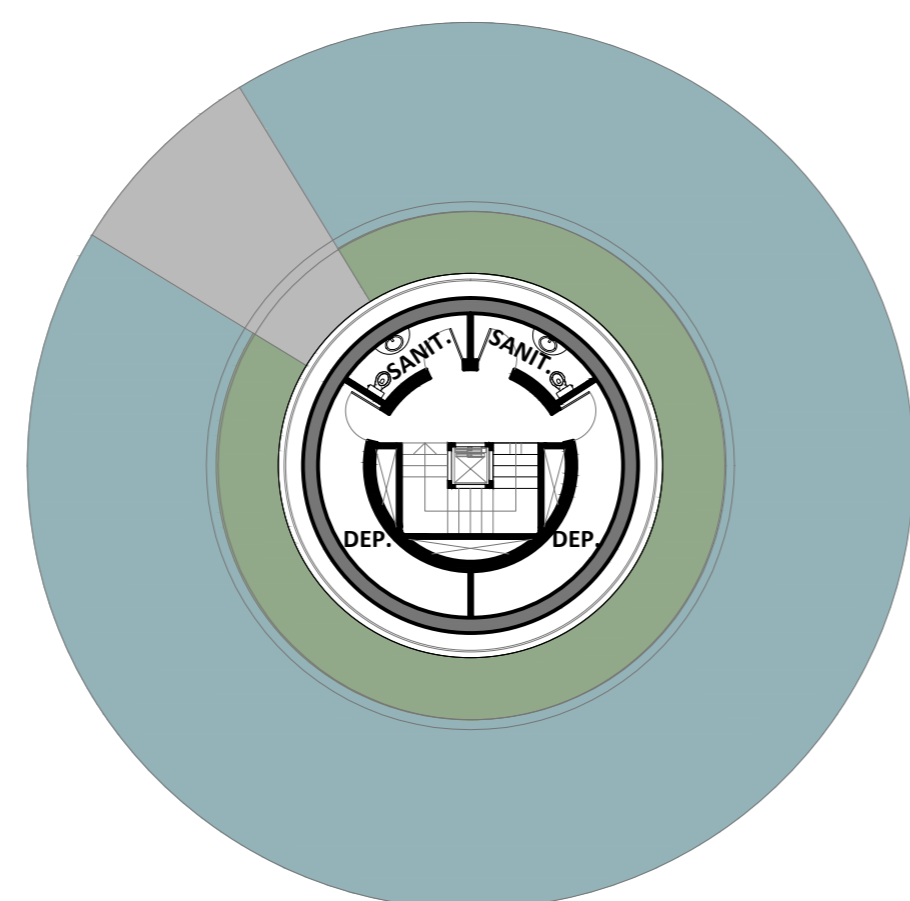

2º pavimento - sanitários

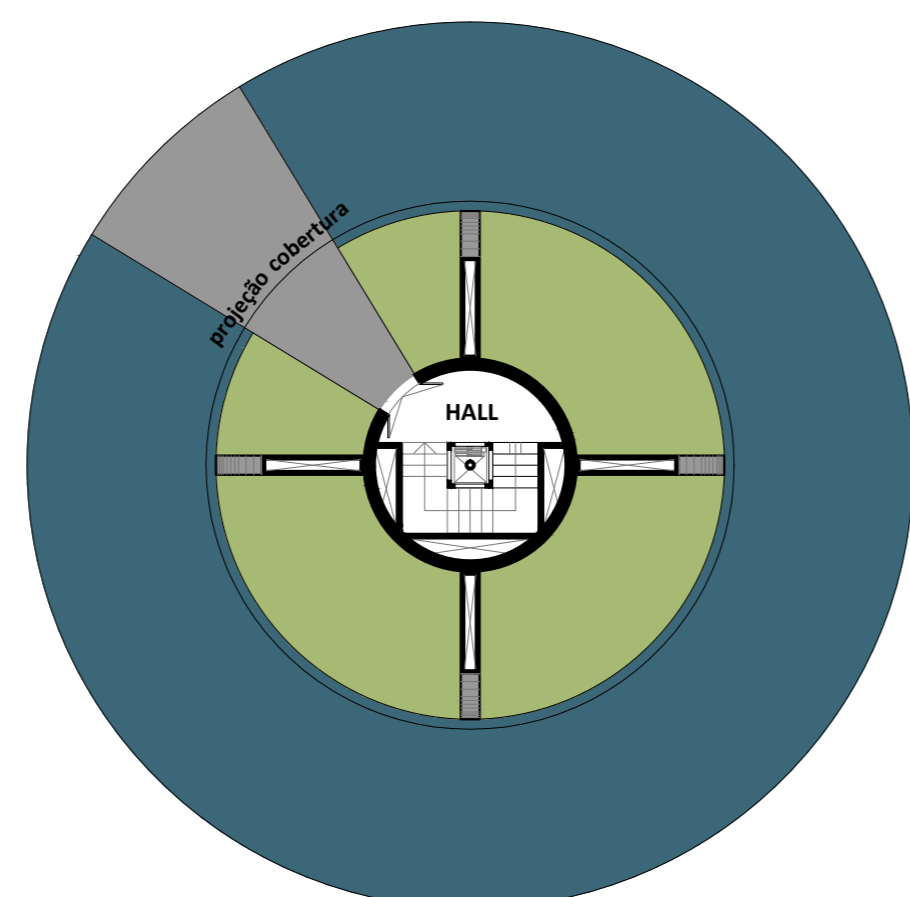

pavimento térreo - hall



## check-in / saguão embarque



## saguão principal

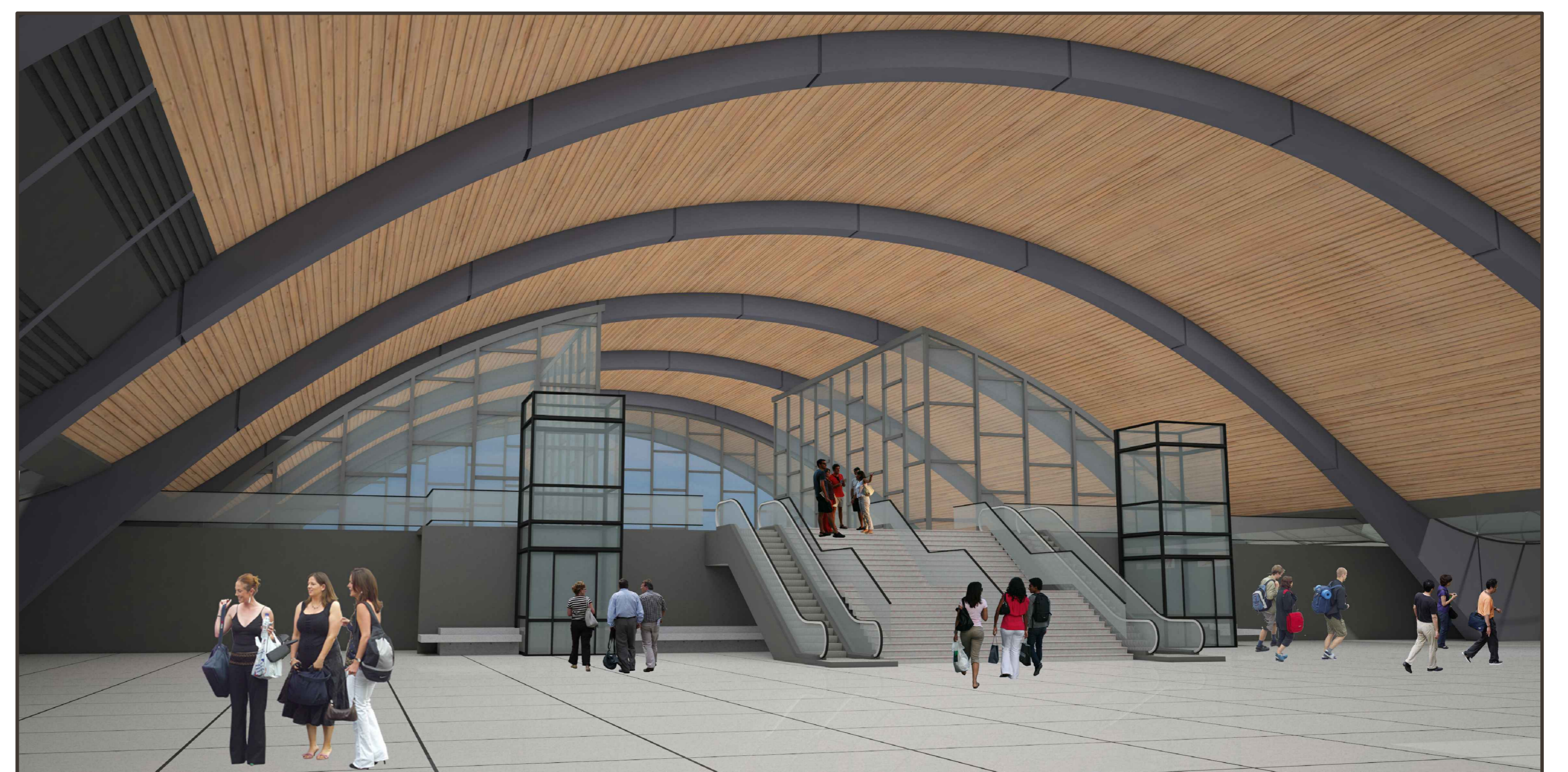

## possibilidades de expansão

### perspectivas

Prevendo uma possível ampliação do Terminal de Passageiros, o atual terminal foi locado de forma que possa ser expandido lateralmente um módulo de arco para cada lateral.

Dessa maneira, poderia-se duplicar a área de embarque e desembarque futuramente.

As salas de embarque e desembarque possuem atualmente pé direito suficiente que permita a possível instalação de mezaninos, de forma que possam ser instalados fingers.

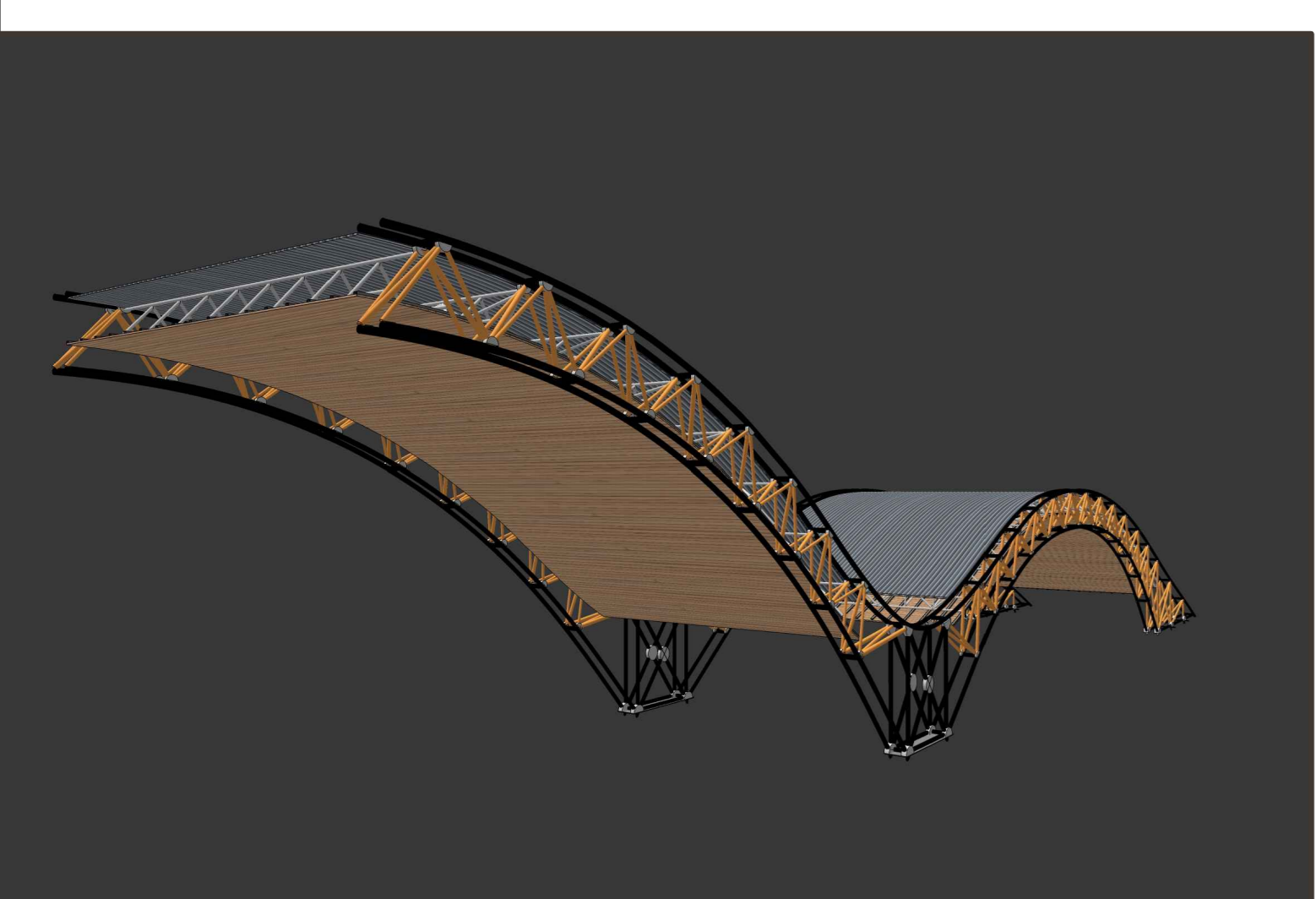
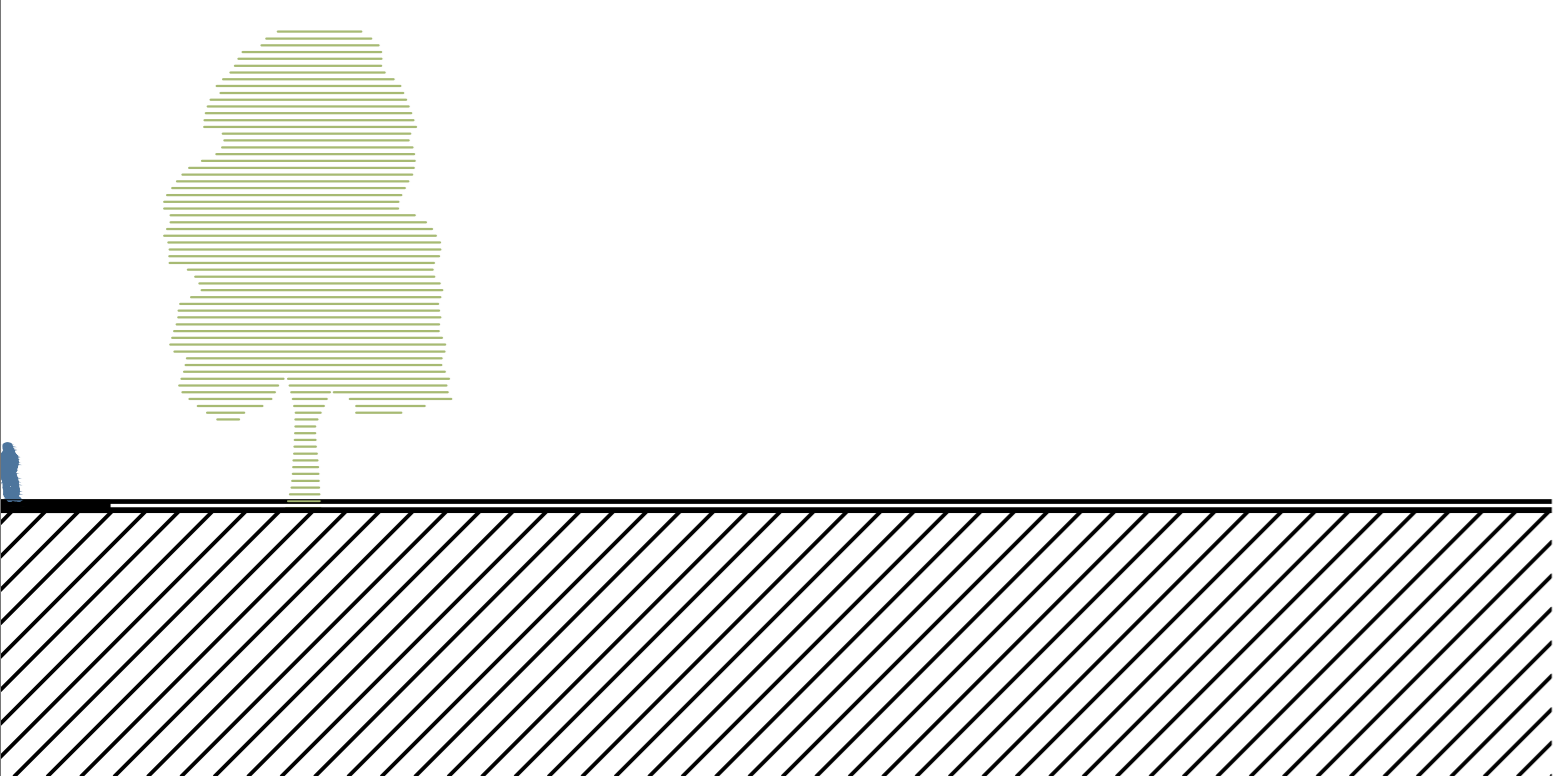
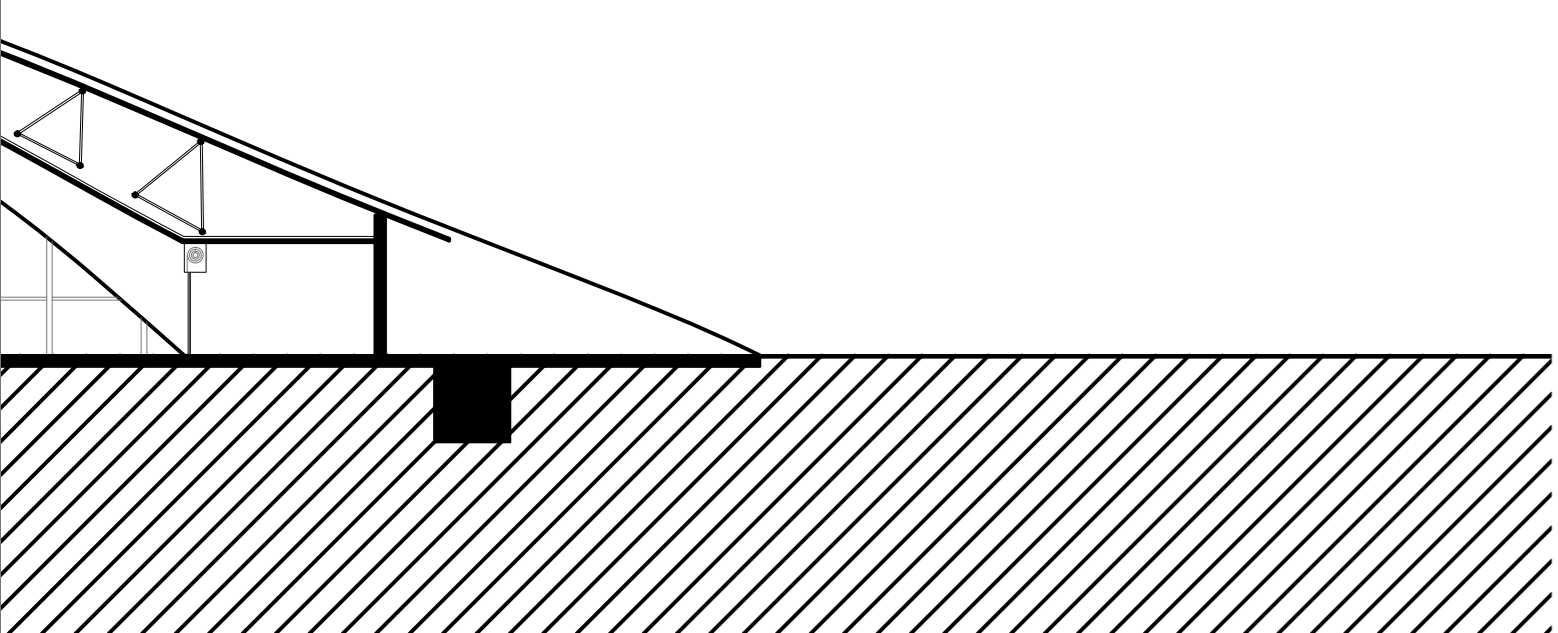
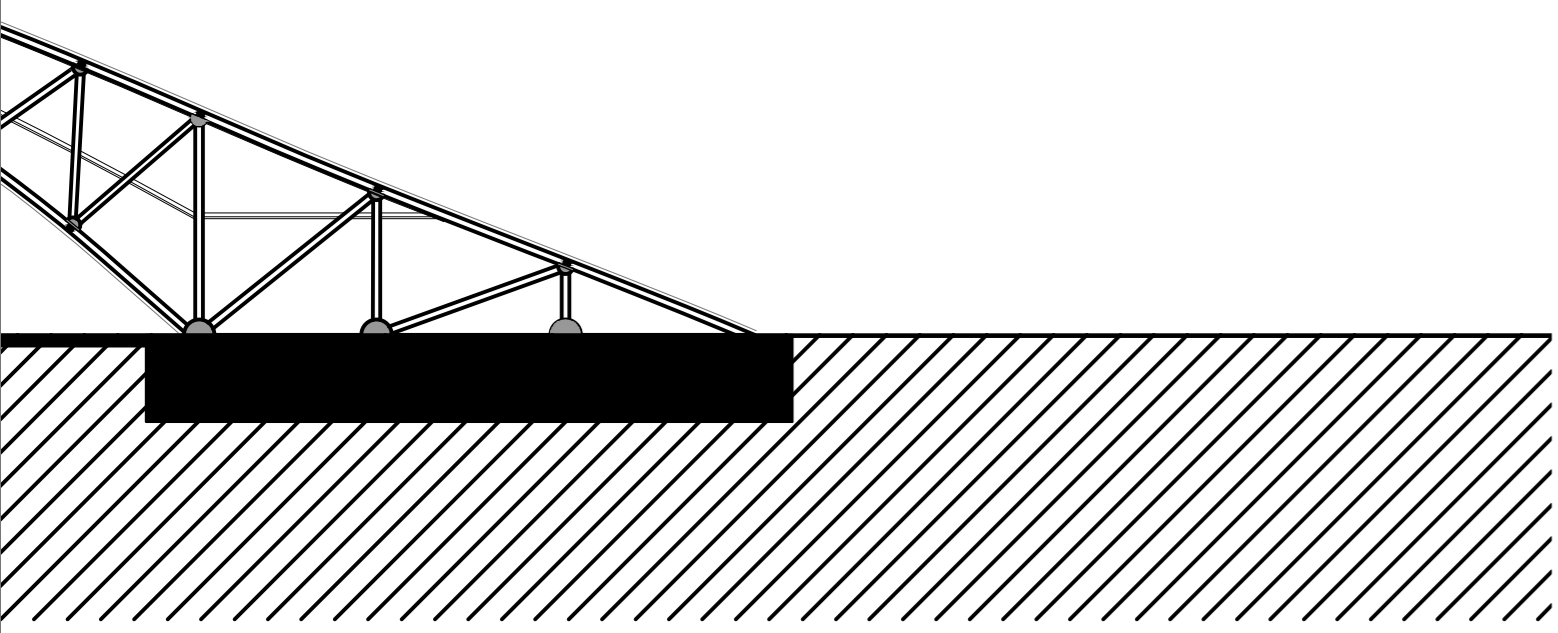
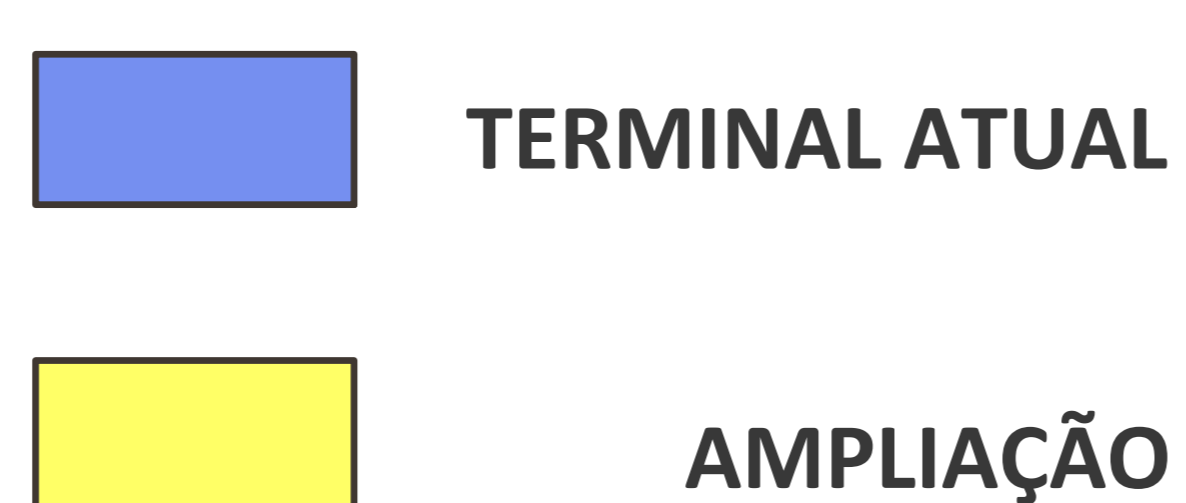
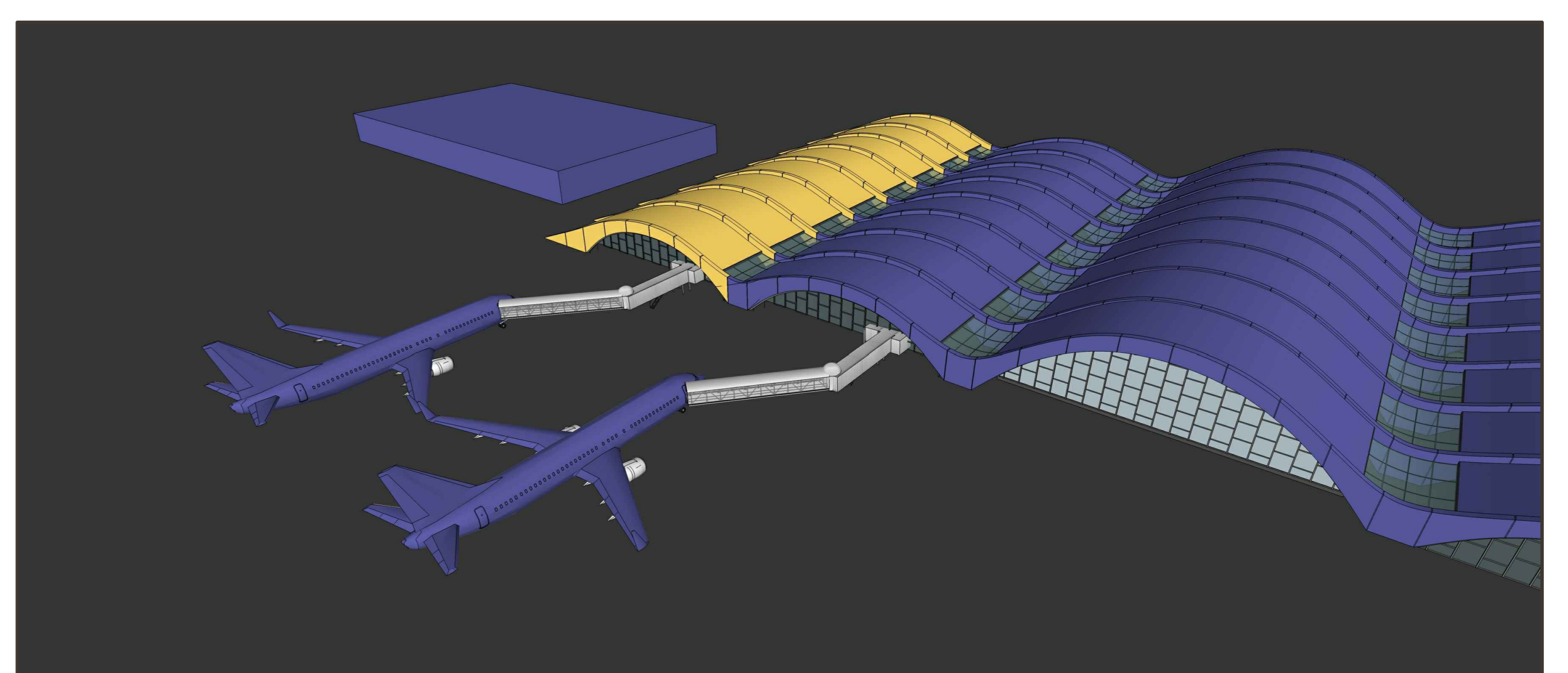
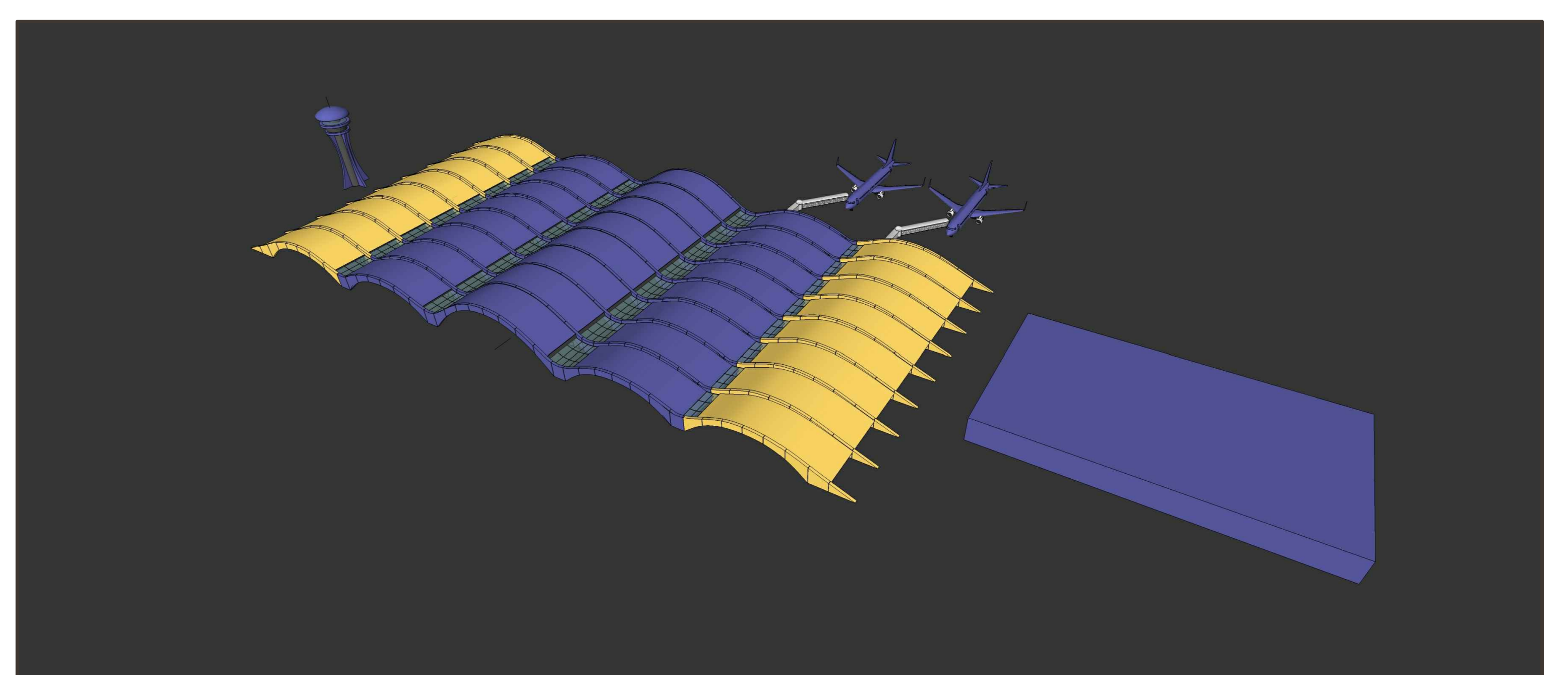

forro de madeira fixado sob as treliças metálicas

6. clarabóia em vidro temperado inclinada para cada arco, de modo que o recolhimento de águas pluviais seja feito na calha e tubo de queda localizados dentro de cada arco.

